

Ask me anything

0 questions

0 upvotes

Exercise: turn this into a UML sequence diagram ...

Every committee is created at a Faculty meeting, where its members and the Chair are proposed and approved. The Chair makes a request to the Faculty secretary to schedule a meeting. All members are contacted and asked to fill out a “doodle” of possible dates. The secretary picks a date available to the Chair and a maximum of members. The secretary books a meeting room and informs all committee members of the selected time and location.



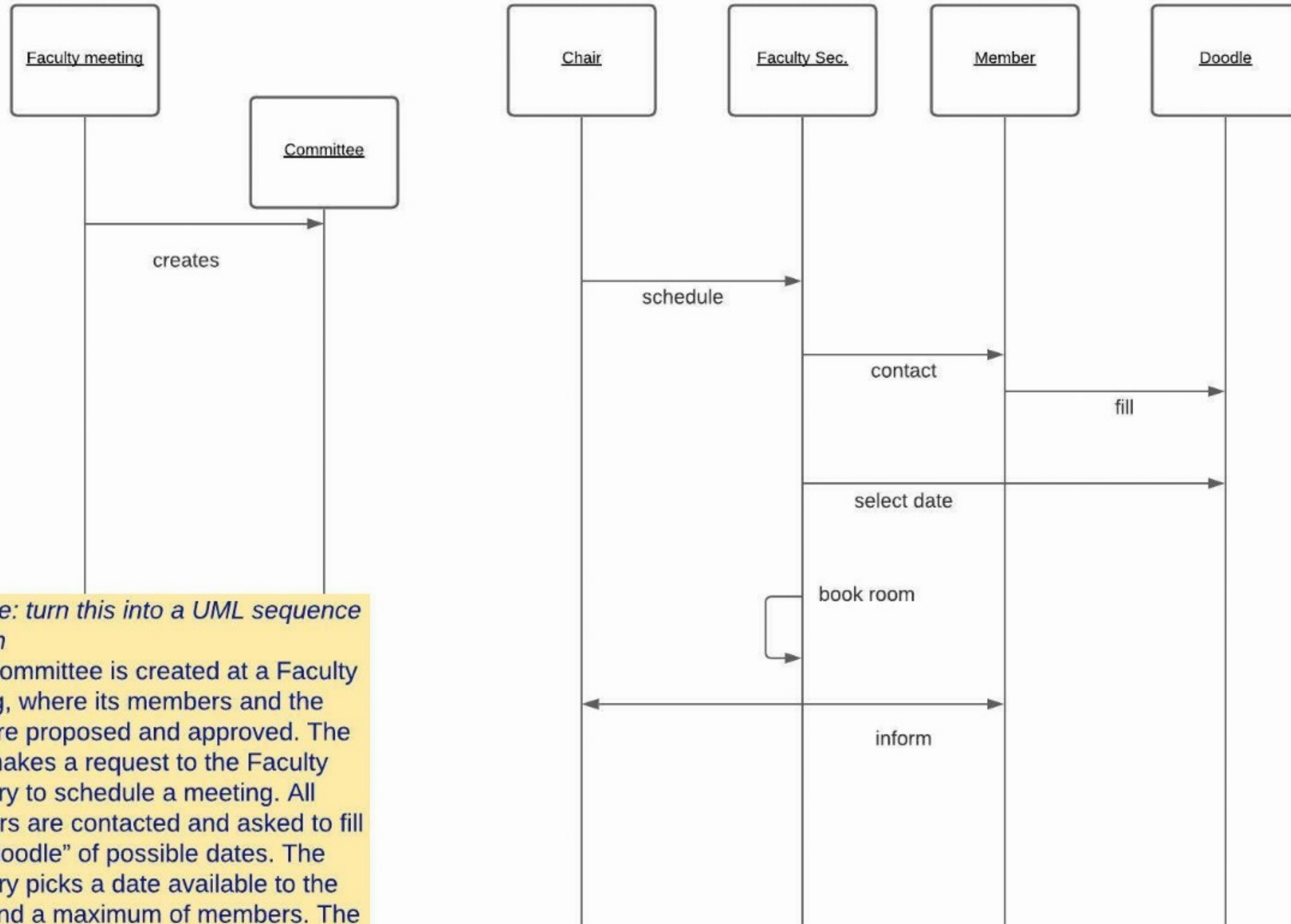

Exercise: turn this into a UML sequence diagram

Every committee is created at a Faculty meeting, where its members and the Chair are proposed and approved. The Chair makes a request to the Faculty secretary to schedule a meeting. All members are contacted and asked to fill out a "doodle" of possible dates. The secretary picks a date available to the Chair and a maximum of members. The secretary books a meeting room and informs all committee members of the selected time and location.



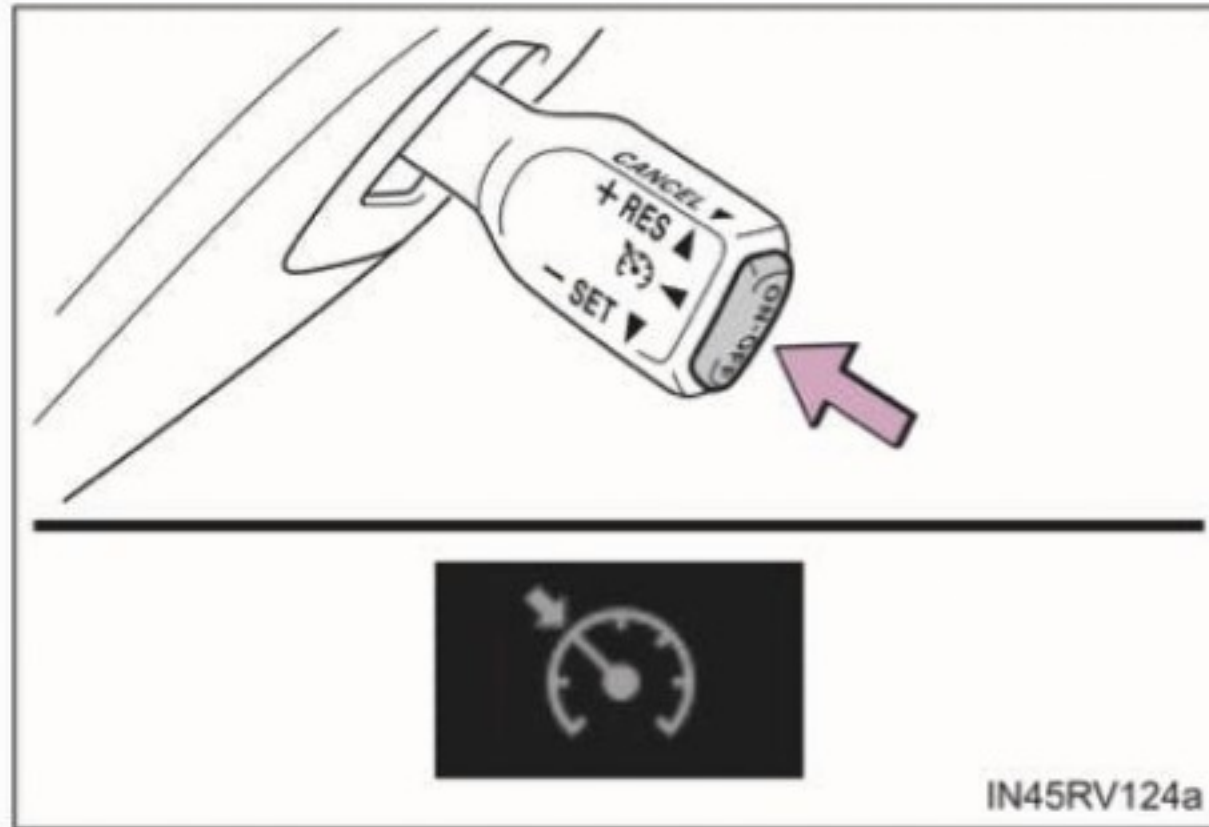

Press the "ON-OFF" button to activate the cruise control.
Press the button again to deactivate the cruise control.

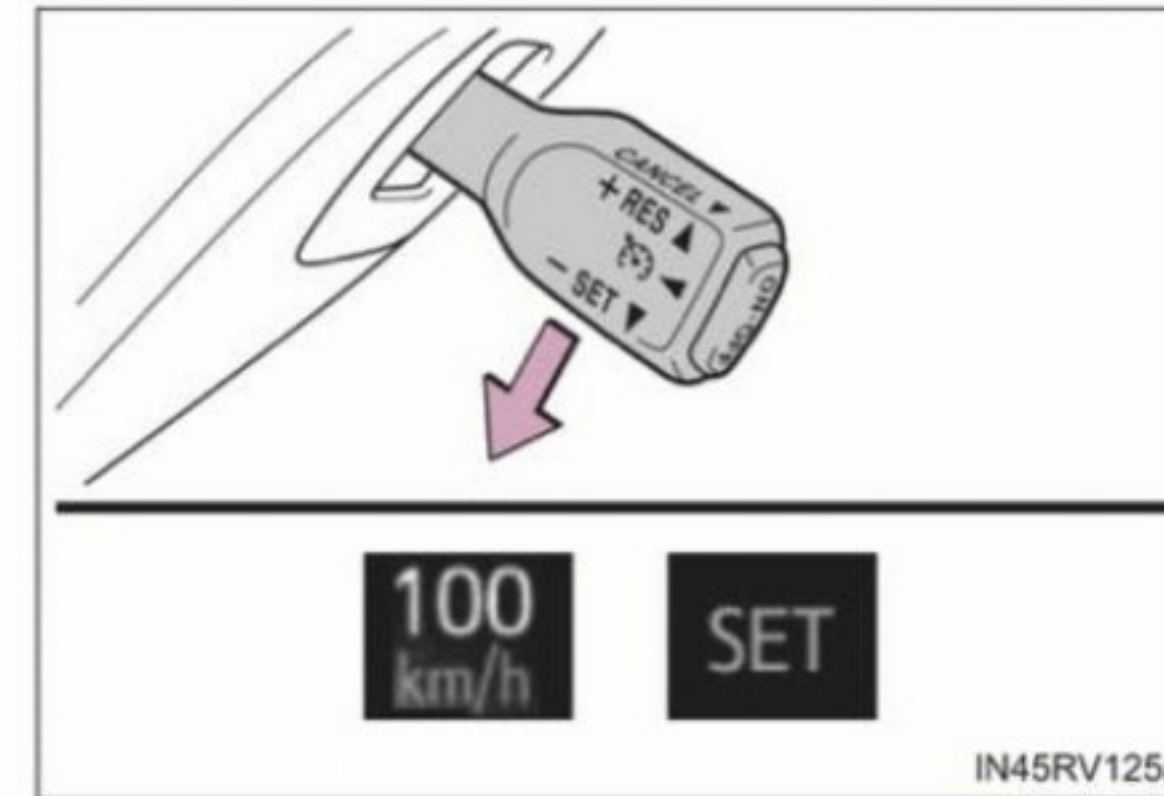

Accelerate or decelerate the vehicle to the desired speed and push the lever down to set the speed.
The vehicle speed at the moment the lever is released becomes the set speed.

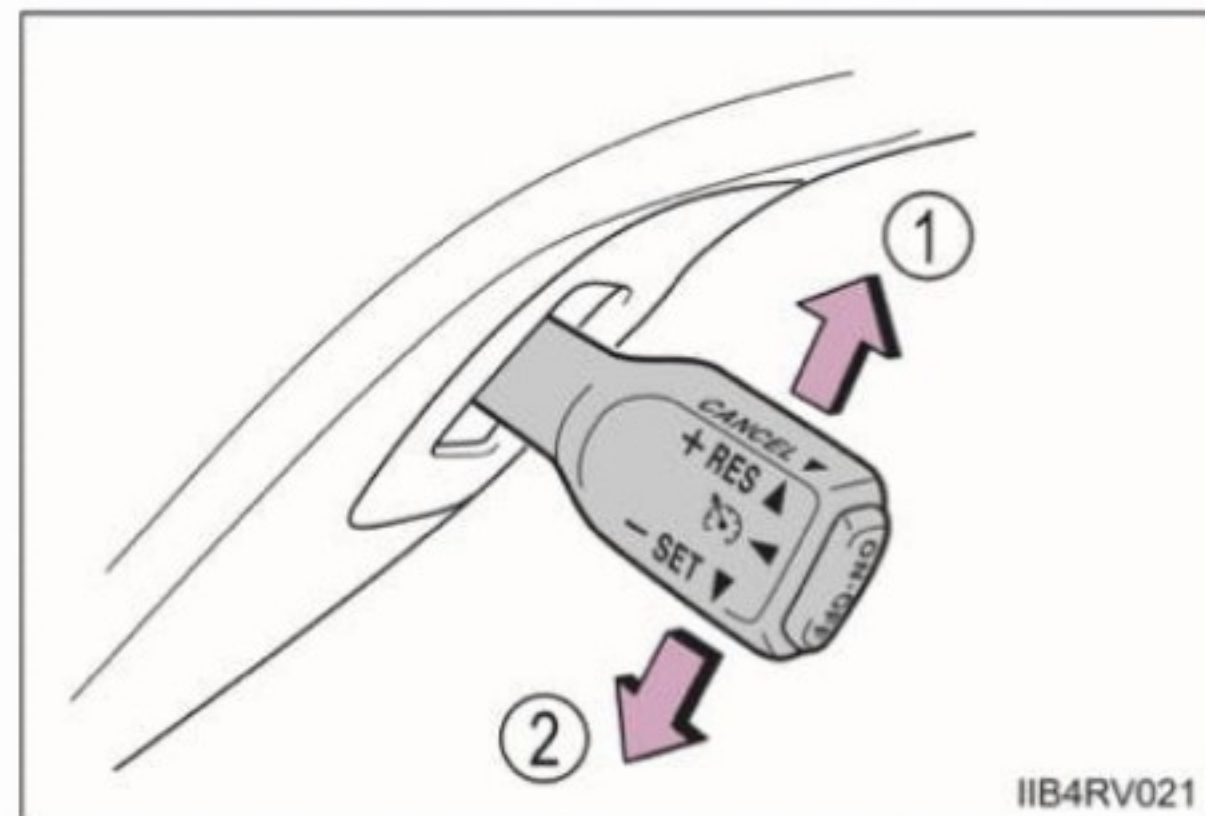

To change the set speed, operate the lever until the desired set speed is obtained.
(1) Increases the speed
(2) Decreases the speed

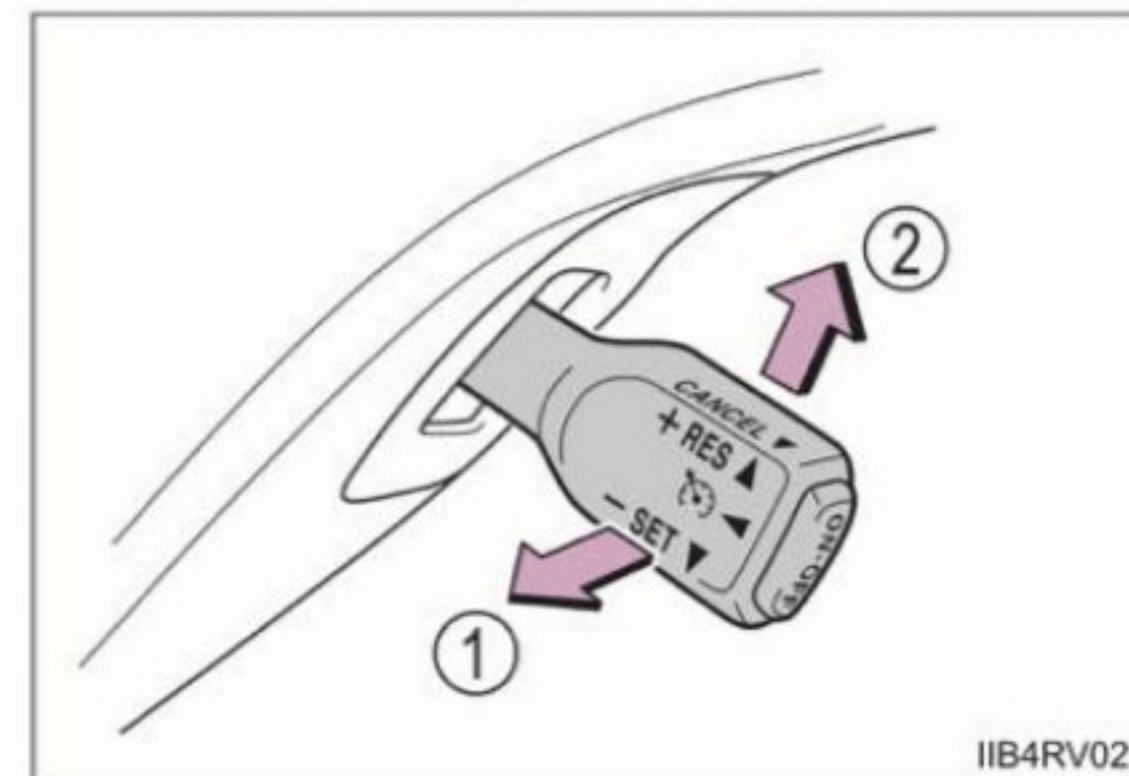

Pulling the lever toward you cancels the constant speed control.
Pushing the lever up resumes the constant speed control.

Exercise: turn this into a UML statechart



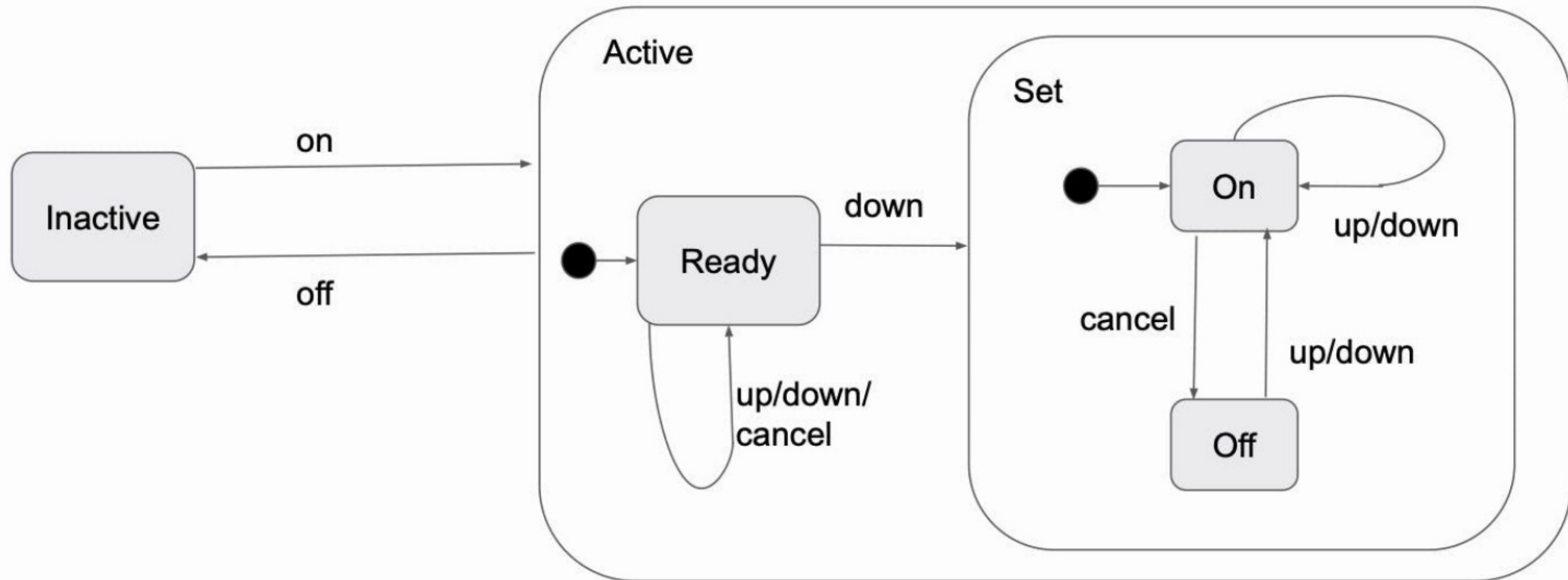

Cruise control statechart

Last chance for questions